

⚠ CAUTION

When installing shock rod piston, spanner wrench must have 1/4 in. x 5/16 in. (6.4mm x 8mm) long pegs to avoid damage to shock rod piston.

6. Apply Loctite Grade "A" (271) to threads on shock rod.
7. Install shock rod piston.
8. Tighten shock rod piston securely to shock rod using spanner wrench (1/4 in. x 5/16 in. long pegs).

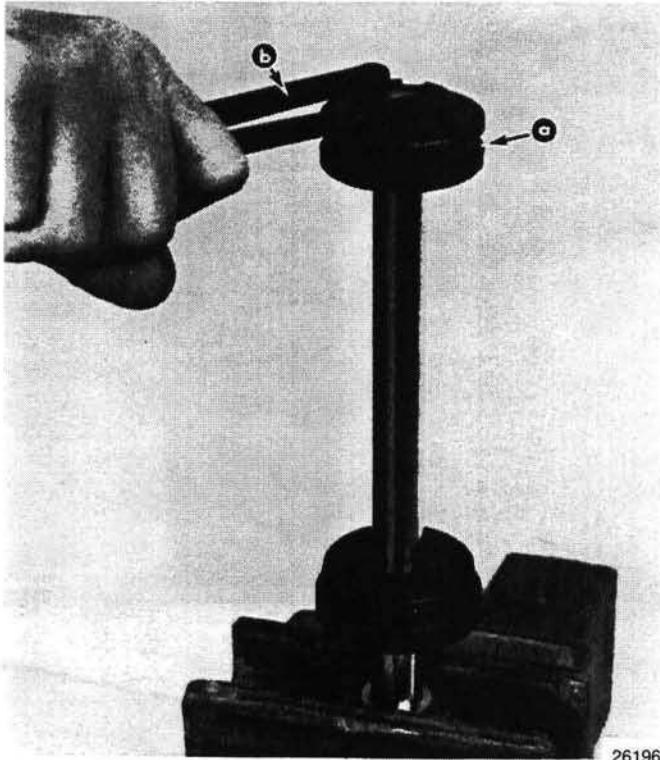

a - Shock Rod Piston
b - Spanner Wrench

9. Remove shock rod assembly from vise.
10. Install lubricated O-ring to shock rod piston.
11. Install ball, seat, and spring (five sets) to shock rod piston.
12. Secure components using plate and screws. Tighten screws securely.

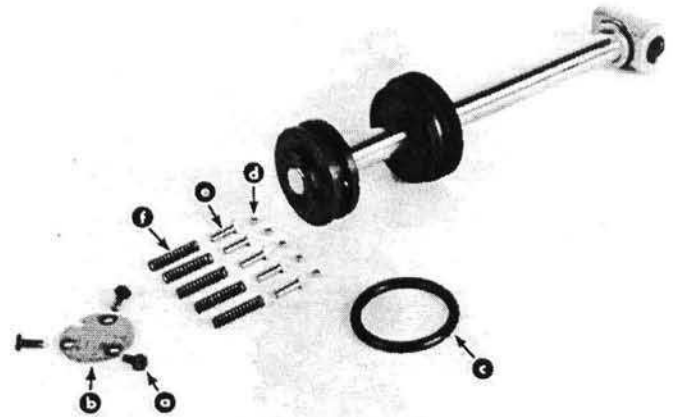

a - Screw
b - Plate
c - O-ring
d - Ball
e - Seat
f - Spring

Shock Rod Installation

1. Place cylinder/manifold assembly into soft jawed vise.
2. Fill cylinder to top using Quicksilver Power Trim and Steering Fluid or; (ATF) Type F, FA or Dexron II.
3. Place cam shaft lever in the open position (lever facing down).
4. Install lubricated O-ring to memory piston and install piston into cylinder three inches (76mm) from top.

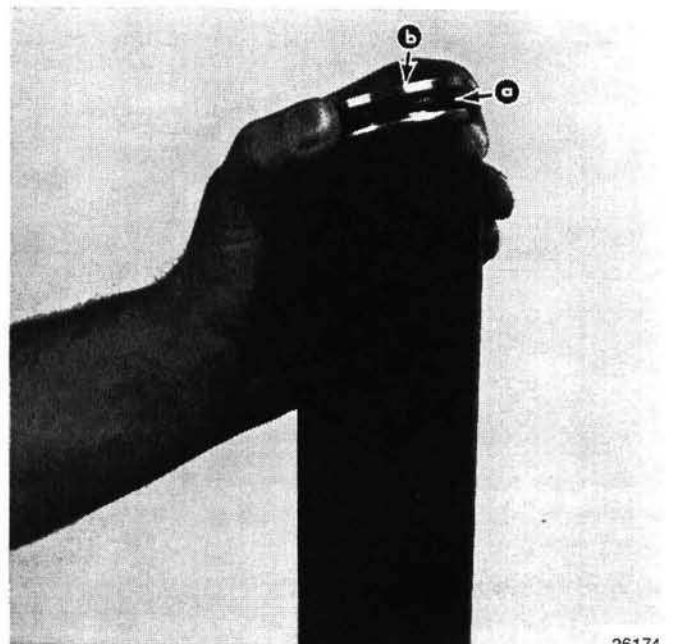

a - O-ring
b - Memory Piston