



# Service Information

## 1. Identification (Engine Serial Number)

Engine serial number is stamped on the swivel bracket of outboard motor body.

- ① Model Name
- ② Model Type
- ③ Serial Number

CE		Tokyo, Made in Japan	
2006 Model	F3.5A	① 3BR	②
SERIAL No.	XXXXXXXXX ③		
RATED POWER	kW		
FULL THROTTLE RANGE	5000	6000	r / min
MASS	18	20	kg

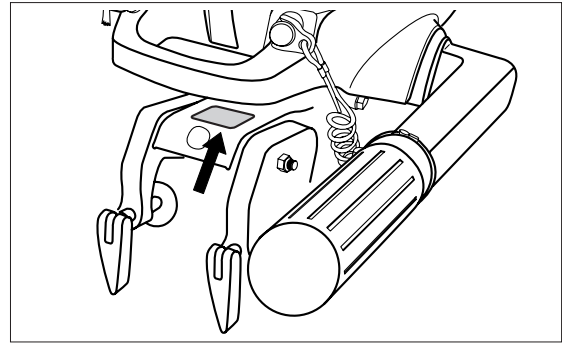

## 2. Securing of work safety

### 1) Fire Prevention

Gasoline is hazardous material and very flammable. Do not handle gasoline near ignition source such as spark or static electricity.

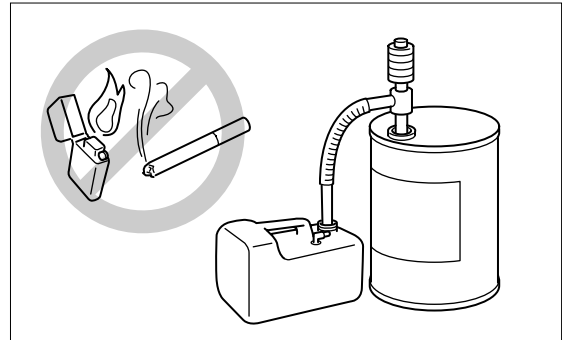

### 2) Ventilation

Exhaust gas or gasoline vapor is hazardous for human health. Be sure to ventilate well when working indoors.

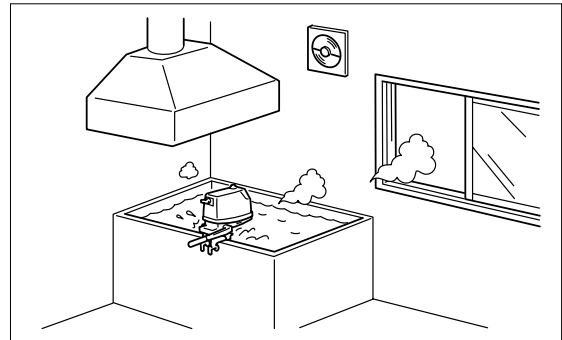

### 3) Protection

Wear a pair of goggles, working gloves and safety shoes to protect your body from chemicals and oils and eyes from particles generated by grinding or polishing. Avoid contact with oil, grease or sealing agent to the skin. In case of exposure to such matters, wash away with soap and warm water immediately.

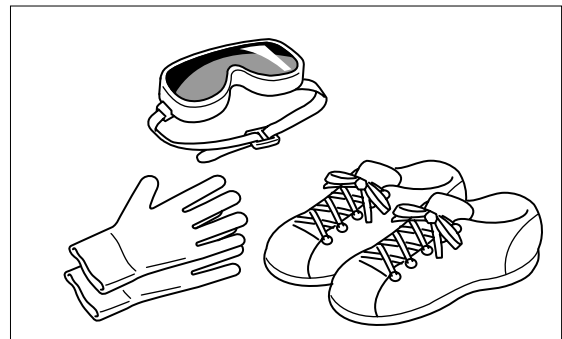

### 4) Genuine Parts

Use parts and/or chemicals that are genuine items or recommended.

